

Metric Conversions

MM	x	0.03937	=	Inches
Inches	x	25.4	=	MM
Grams	x	0.03527	=	Ounces
Ounces	x	28.349527	=	Grams

EAGLE ROCK[®]
TECHNOLOGIES

Wettstein Tool[™]

Turning Accessories

No. A1-33

BUSHETTE[®] Collet Type Tool Holders

An excellent alternative to bushings. The **BUSHETTE Tool Holders** are designed especially for CNC Lathes and Turning Centers where tools must be practical and hard working to keep your machines competitive in today's tough market. Excellent for presetting backup tooling and setting up for your next job.

All **BUSHETTE's** are fully hardened and precision ground. Available for 5C, R8, 3C, 3AT, 2MT and 3J Collets.

Collet Stops are included with all 5C BUSHETTE's.

A great way to make use of the Collets lying around the shop.



Type I Bushette Unobstructed "Through Hole" For 5C, 3C, 3AT and 3J Collets

The design of these collets allows for an unobstructed through hole. Tools can extend beyond the back of the **Bushette**.

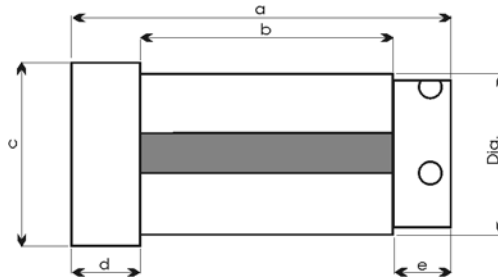

Type II Bushette Obstructed "Through Hole" For R8 and 2MT Collets

The design of these collets do not allow tooling to extend beyond the interior depth of the collet.

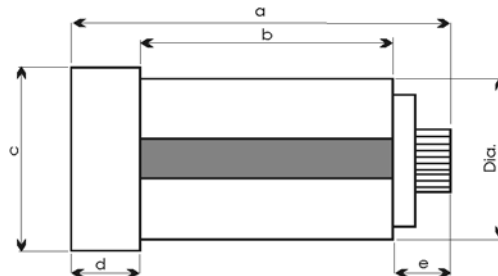

EAGLE ROCK[®] TECHNOLOGIES INC.

*Manufacturers of Specialty
Tooling and Accessories since 1963*

One Eagle Rock Drive
Bath, Pennsylvania
18014-9648

1-610-759-5200 • Fax: 1-610-759-4340

1-800-EAGLEROCK • 1-800-324-5376

www.EagleRockONLINE.com

Metric Conversions

MM x 0.03937 = Inches
 Inches x 25.4 = MM
 Grams x 0.03527 = Ounces
 Ounces x 28.349527 = Grams

EAGLE ROCK[®]
TECHNOLOGIES

Wettstein Tool[™]

Turning Accessories

No. A1-33 (continued)

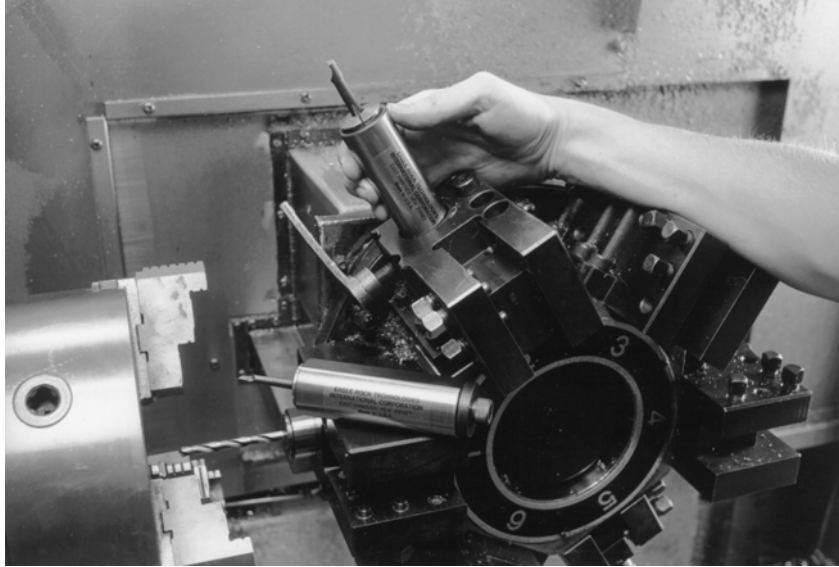

Collet Type	Dia.	a	b	c	d	e	Cat. No.
2MT	1"	3 ¹ / ₄	2 ¹ / ₄	1 ¹ / ₈	3 ¹ / ₄	1 ¹ / ₄	A1-33-2MT1000
2MT	1 ¹ / ₄ "	3 ¹ / ₄	2 ¹ / ₄	1 ¹ / ₈	3 ¹ / ₄	1 ¹ / ₄	A1-33-2MT1250
2MT	1 ¹ / ₂ "	3 ¹ / ₄	2 ¹ / ₄	1 ⁵ / ₈	3 ¹ / ₄	1 ¹ / ₄	A1-33-2MT1500
2MT	1 ³ / ₄ "	3 ³ / ₄	2 ³ / ₄	1 ⁷ / ₈	3 ¹ / ₄	1 ¹ / ₄	A1-33-2MT1750
2MT	2"	3 ³ / ₄	2 ³ / ₄	2 ¹ / ₈	3 ¹ / ₄	1 ¹ / ₄	A1-33-2MT2000
3AT	1"	3 ¹ / ₄	2 ¹ / ₄	1 ¹ / ₈	3 ¹ / ₄	1 ¹ / ₄	A1-33-3AT1000
3AT	1 ¹ / ₄ "	3.35	2 ¹ / ₄	1 ⁵ / ₈	3 ¹ / ₄	.35	A1-33-3AT1250
3AT	1 ¹ / ₂ "	3.35	2 ¹ / ₄	1 ⁵ / ₈	3 ¹ / ₄	.35	A1-33-3AT1500
3AT	1 ³ / ₄ "	3.35	2 ¹ / ₄	1 ⁷ / ₈	3 ¹ / ₄	.35	A1-33-3AT1750
3AT	2"	3.85	2 ³ / ₄	2 ¹ / ₈	3 ¹ / ₄	.35	A1-33-3AT2000
3J	3"	4 ¹ / ₈	4 ¹ / ₄	—	—	5 ⁵ / ₈	A1-33-3J3000
3J	3 ¹ / ₂ "	5 ⁷ / ₈	5 ¹ / ₄	—	—	5 ⁵ / ₈	A1-33-3J3500
3C	1"	3 ¹ / ₄	2 ¹ / ₄	1 ¹ / ₈	3 ¹ / ₄	1 ¹ / ₄	A1-33-3C1000
3C	1 ¹ / ₄ "	3.35	2 ¹ / ₄	1 ⁵ / ₈	3 ¹ / ₄	.35	A1-33-3C1250
3C	1 ¹ / ₂ "	3.35	2 ¹ / ₄	1 ⁵ / ₈	3 ¹ / ₄	.35	A1-33-3C1500
3C	1 ³ / ₄ "	3.35	2 ¹ / ₄	1 ⁷ / ₈	3 ¹ / ₄	.35	A1-33-3C1750
3C	2"	3.85	2 ³ / ₄	2 ¹ / ₈	3 ¹ / ₄	.35	A1-33-3C2000
5C	1 ¹ / ₂ "	4 ¹ / ₄	2	2	3 ¹ / ₄	3 ¹ / ₄	A1-33-5C1500
5C	1 ³ / ₄ "	4 ¹ / ₈	2 ³ / ₄	2	3 ¹ / ₄	5 ⁵ / ₈	A1-33-5C1750
5C	2"	4 ¹ / ₈	2 ³ / ₄	2 ¹ / ₈	3 ¹ / ₄	5 ⁵ / ₈	A1-33-5C2000
5C	2 ¹ / ₂ "	4 ⁵ / ₈	3 ¹ / ₄	2 ⁵ / ₈	3 ¹ / ₄	5 ⁵ / ₈	A1-33-5C2500
R8	1 ¹ / ₂ "	4 ⁷ / ₈	3 ¹ / ₂	1 ³ / ₄	3 ¹ / ₄	5 ⁵ / ₈	A1-33-R81500
R8	1 ³ / ₄ "	4 ⁷ / ₈	3 ¹ / ₂	1 ⁷ / ₈	3 ¹ / ₄	5 ⁵ / ₈	A1-33-R81750
R8	2"	4 ⁷ / ₈	3 ¹ / ₂	2 ¹ / ₈	3 ¹ / ₄	5 ⁵ / ₈	A1-33-R82000
R8	2 ¹ / ₂ "	4 ⁷ / ₈	3 ¹ / ₂	2 ⁵ / ₈	3 ¹ / ₄	5 ⁵ / ₈	A1-33-R82500

All 5C BUSHETTE's include Collet Stops

EAGLE ROCK[®] TECHNOLOGIES INC. *Manufacturers of Specialty Tooling and Accessories since 1963*

One Eagle Rock Drive
 Bath, Pennsylvania
 18014-9648

1-610-759-5200 • Fax: 1-610-759-4340
 1-800-EAGLEROCK • 1-800-324-5376
www.EagleRockONLINE.com